

Specifications

DIMENSIONS: 8.5" D 7.5"H

WEIGHT: 5 lbs.

AIR FLOW (C.F.M.): 20 and 40

SERVICE AREA: 75-150 sq.ft.†

† Based on 2 to 4 air change-overs per hour, recommended for people with sensitivities

POWER CONSUMPTION: 4.5 Watts

HEPA SURFACE AREA: 19 sq.ft.

CLASSIFICATION

- Portable HEPA (High Efficiency Particulate Air) 100% Sealed Air Cleaning Device
- U.L. and C.S.A. approved

MATERIALS: 24 gauge cold rolled steel

FINISH: Powder coated baked enamel

COLOR: Sandtext White

INTAKE (Upper Section)

Three-stage filter cartridge:
Integrated HEPA filter cartridge with washable prefilter and V.O.C. filter

OUTFLOW (Lower Section)

330 degree perimeter outflow

MOTOR/FAN

- Designed for continuous operation
- Run tested for 35,000 hours

CONTROL: 3-position, 2-speed switch

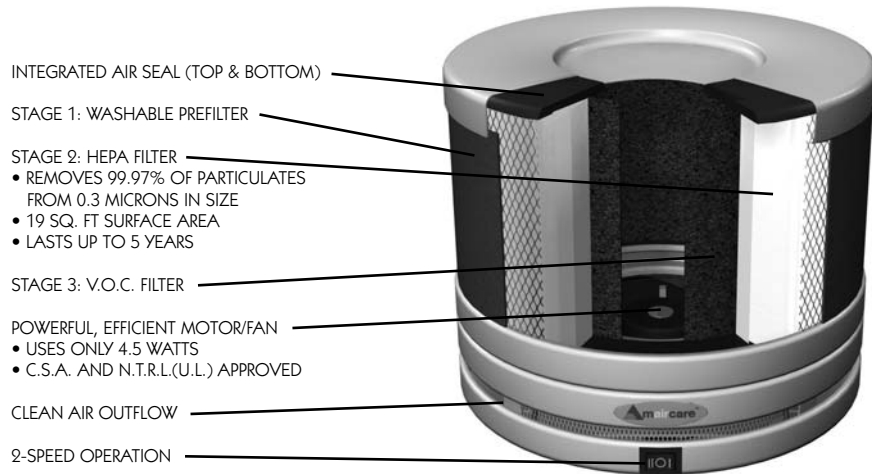

Limited Warranty

The motor/fan in this Amaircare® product is warranted by Amaircare Corporation to the original retail purchaser for FIVE (5) YEARS from the date of purchase. All other components (except filters) are warranted for ONE (1) YEAR. Amaircare will repair or replace at its option the component(s) which upon inspection by an authorized Amaircare® dealer proves to have failed in normal use, due to defects in material or workmanship, or, at its option, to replace the unit. Operations other than those recommended in this manual or at voltages other than that specified on the unit, or any attempts by unauthorized personnel to service or modify the unit will void the warranty.

WARRANTY SERVICE IS AVAILABLE BY BRINGING YOUR UNIT, OR SENDING IT POSTAGE PREPAID, WITH PROOF OF PURCHASE TO THE VENDOR WHO SOLD YOU THE UNIT.

Roomaid®

Portable Air Filtration System Instruction Manual

Read and keep this manual for reference purposes



maircare®
Cleaning the air you breathe.

Congratulations on your purchase of a Roomaid™ portable air filtration system! With proper care and maintenance your Roomaid™ will provide years of reliable service and improve the quality of your air.

Operating Instructions

1. Set the unit down on a dresser, desk or other piece of sturdy furniture.
2. Using the adapter cord, insert the small plug into the receptacle at the back of the unit. Plug the other end into a wall receptacle.
3. Choose a speed setting and let the unit run continuously.

PLEASE NOTE:

- **THE FIRST TIME YOU USE YOUR ROOMAID™** let the unit run on the high-speed setting for several hours before using the room. This gives the unit time to stir up and filter out excess dust. It is also a good idea to vacuum and dust the room before using the unit for the first time. After the initial cleaning period, let the unit run continuously. Use the high-speed setting for maximum performance.
- **The AC ADAPTOR** may feel fairly warm to the touch when it is plugged into a wall receptacle. This is normal.
- **DO NOT SIT ON THE UNIT OR PLACE ANYTHING HEAVY ON TOP OF IT.**

Cleaning your Roomaid™

Use a soft, damp cloth to clean the unit. You can also use a non-abrasive cleaner. Do not let water get into the filters or the motor/fan housing.

About Roomaid's three-stage filtration and changing filters

Stage 1: Washable Prefilter

The prefilter prolongs the life of the HEPA filter by removing large particulates before they can reach the HEPA filter. Clean the prefilter when it starts becoming visibly covered with dust. Wash it in your washing machine or hand-wash it with warm water and detergent. Let it dry thoroughly before replacing it. Two prefilters are provided. Use the second prefilter while the other is drying.

Change the prefilter if it no longer fits snugly, or it gets damaged.

Stage 2: HEPA Cartridge

HEPA media with 99.97% efficiency @ 0.3 microns.

Replace every 2-5 years depending on usage and your environment-e.g. smoking vs. non-smoking

Stage 3: V.O.C. Filter

The V.O.C. (Volatile Organic Compound) filter removes household chemicals that may off-gas from household cleaners, paints, solvents, carpets, furniture and other materials containing chemical substances.

Replace every 6-12 months depending on usage.

HEPA Filter Replacement

As the HEPA filter captures particulates, it will darken over time. Replace the HEPA filter when it darkens to example D.

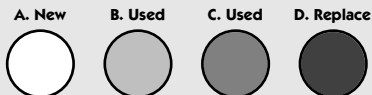

Filter Replacement Instructions

Prefilter Replacement

1. Turn the unit off and unplug it.
2. Remove the used prefilter and carefully discard it in a plastic bag.
3. Line up the seam in the prefilter with the receptacle at the back of the unit. Pull the new prefilter over the unit so it snugly covers the screen.
4. Plug the unit in and turn it on.

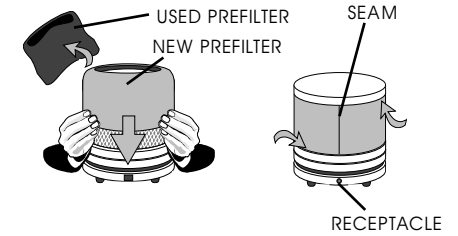

V.O.C. Filter Replacement

1. Turn the unit off and unplug it.
2. Turn the unit up-side down. With one hand holding the HEPA cartridge, pull the motor/fan housing off.
3. Remove the used V.O.C. filter and carefully discard it in a plastic bag.
4. Roll the new V.O.C. filter into a cylinder smaller than the size of the opening in the HEPA cartridge. Insert the V.O.C. filter all the way into the well and spread it open against the HEPA filter.
5. Sit the motor/fan housing right side up and seat the gasket in the groove.
6. Place the HEPA cartridge on the motor/fan housing and align the plugs in the cartridge with the holes in the housing. Once the holes are aligned press firmly on the top of the cartridge to secure it to the housing.
7. Plug the unit in and turn it on.

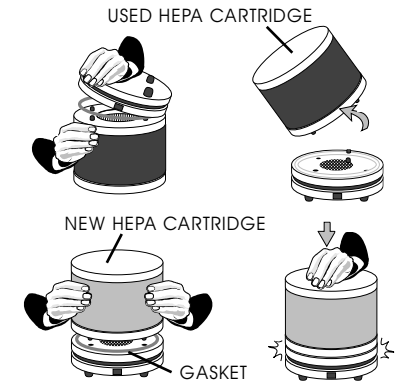
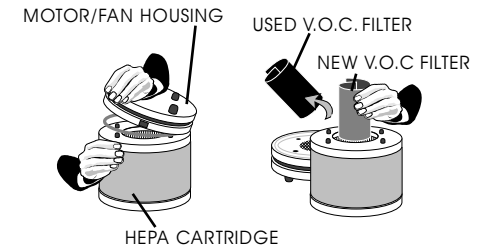

HEPA Cartridge Replacement

1. Turn the unit off and unplug it.
2. Turn the unit up-side down. With one hand holding the HEPA cartridge, pull the motor/fan housing away. Discard the cartridge in a plastic bag.
3. Sit the motor/fan housing right side up and seat the gasket in the groove.
4. Place the HEPA cartridge on the motor/fan housing and align the plugs in the cartridge with the holes in the housing. Once the holes are aligned press firmly on the top of the cartridge to secure it to the housing.
6. Plug the unit in and turn it on.